



Manufacturer and Supplier of  
**Restaurant Equipment**  
 and *Display Cases*  
 for the Food Service Industry



# MODEL: BBC-6024-SC

## PRODUCT FEATURES

Self-Contained System  
 Black vinyl front and ends  
 Side mounted Compressor  
 Heavy Duty Stainless Steel Top  
 Two Doors  
 Temperature range 36°F to 41°F  
 1/3 HP, 115V, 9.2AMPs  
 Enviromentally Friendly 134A Refrigerant

Sliding glass doors optional

|                   |                         |
|-------------------|-------------------------|
| Casters           | 5" Casters Option       |
| Warranty          | 1 yr Parts & compressor |
| Front Door        | Black Vinyl             |
| Front Motor Cover | Black Vinyl             |
| Interior Walls    | Staineless Steel        |
| Outside Back      | Galvanized              |

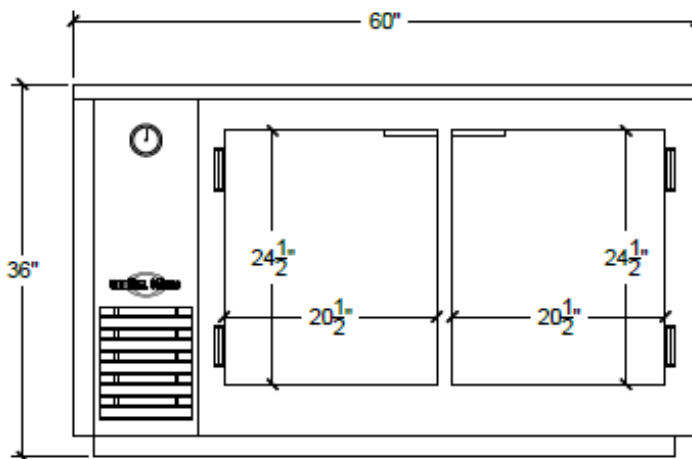
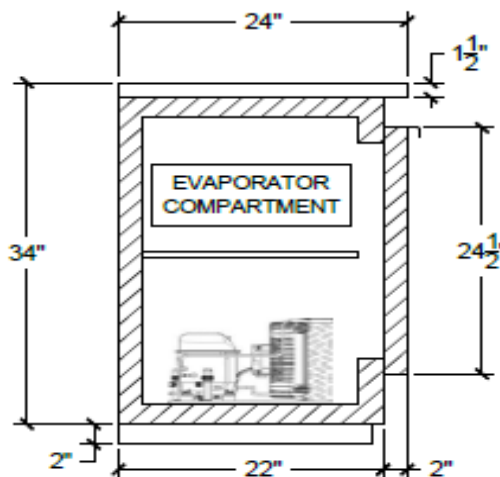

### Product Specifications

| Dimensions      | Doors | Shelves | Cooling Cycle | Refrigerant | HP  | Power    | Ampr. | BTU | Freon (oz) |
|-----------------|-------|---------|---------------|-------------|-----|----------|-------|-----|------------|
| 60" x 32" x 36" | 2     | 2       | 33-41         | 134a        | 1/3 | 115/60/1 | 8.5   | 900 | 11.5       |

### Additional Models

| Model #     | Doors | Shelves | Cooling Cycle | Refrigerant | HP  | Power    | Ampr. | BTU  | Freon (oz) |
|-------------|-------|---------|---------------|-------------|-----|----------|-------|------|------------|
| BBC-4824-SC | 2     | 2       | 33-41         | 134a        | 1/2 | 115/60/1 | 8.5   | 900  | 11.5       |
| BBC-7224-SC | 3     | 3       | 33-41         | 134a        | 3/4 | 115/60/1 | 9     | 1150 | 11.5       |

\* Model number designates product length. Due to product improvement, we reserve the right to change specifications without notice.